



125 Overbrook Road

Hardwicke, Gloucester, GL2 4RZ

£160,000



Murdock & Wasley Estate Agents are delighted to welcome to the open market this two bedroom terraced house situated in a popular and convenient location. In need of modernisation throughout this property is offered to the market with no onward chain and is an ideal investment opportunity.

To avoid disappointment, we highly advise scheduling an early viewing !



Entrance Hall

Accessed via upvc double glazed door. Opening to:

Kitchen

Range of base, wall and drawer mounted units, roll edge worktops, stainless steel sink unit with a mixer tap over. Appliance points, power points, oven/ grill with four ring induction hob, space for washing machine, dishwasher, fridge and freezer. Partly tiled walls, front aspect upvc double glazed window.

Lounge/ Diner

Tv point, power points, stairs to first floor landing. Rear aspect upvc double glazed window and French doors leading to the garden.

Landing

Access to loft space, power points. Doors lead off:

Bedroom One

Power points, rear aspect upvc double glazed window.

Bedroom Two

Power points, front aspect upvc double glazed window.

Bathroom

Suite comprising panelled bath with shower attachment, low level wc, pedestal wash hand

basin. Shaver point, partly tiled walls, vinyl flooring, front aspect upvc frosted double glazed window.

Outside

To the rear of the property there is an enclosed garden with an artificial lawn and wooden shed.

Tenure

Freehold

Local Authority

Gloucester City Council
Council Tax Band: B

Services

Mains water, gas, electricity and drainage.

Awaiting Vendor Approval

Details are yet to be approved by the vendor and may be subject to change. Please contact the office for more information.

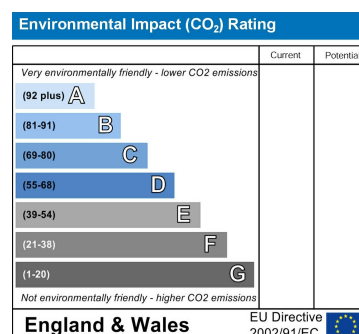
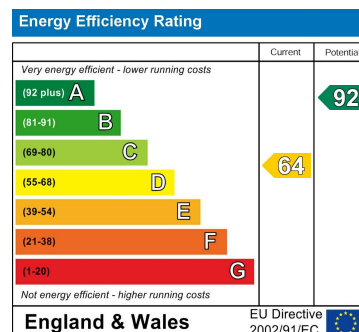
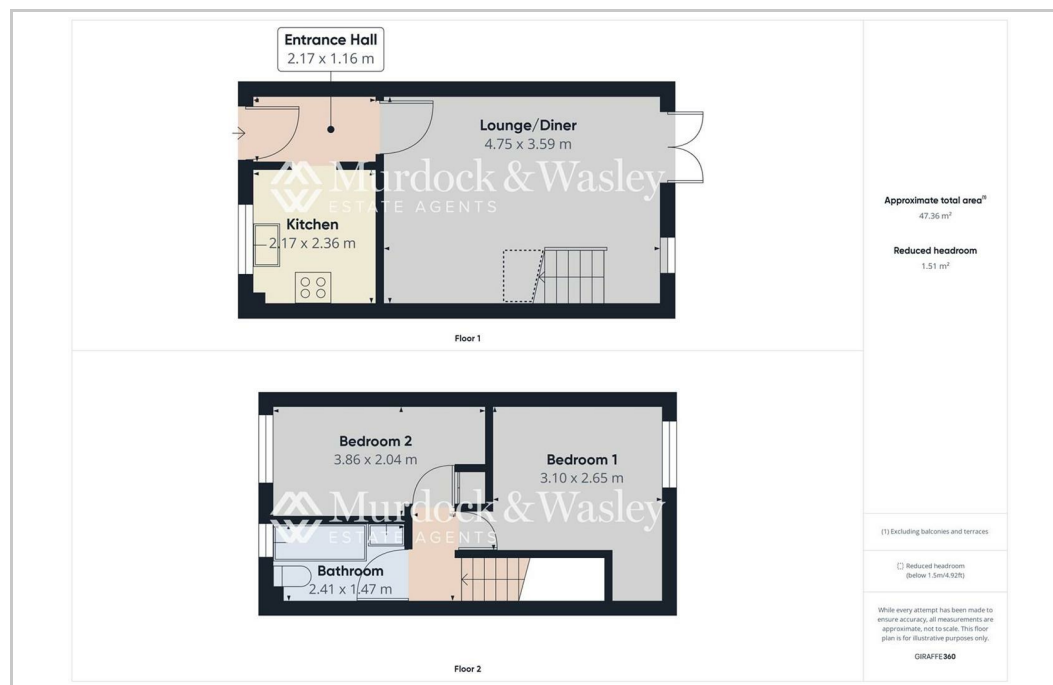

These particulars, whilst believed to be accurate are set out as a general outline only for guidance and do not constitute any part of an offer or contract. Intending purchasers should not rely on them as statements of representation of fact, but must satisfy themselves by inspection or otherwise as to their accuracy. No person in this firm's employment has the authority to make or give any representation or warranty in respect of the property.

95 Maidenhall, Highnam, Gloucester, GL2 8DJ email: office@mwea.co.uk

GLOUCESTER 01452 682952 FOREST OF DEAN 01594 888624 WWW.MWEA.CO.UK

Murdock & Wasley Estate Agents Ltd, Registered in England No. 12622907 at Maidenhall, Highnam, Gloucester, GL2 8DJ

